

Comprehensive protection,

from PCM Technologies

Because data is normally encrypted, data exchange cannot be monitored or seen by a firewall.

For this reason, several components are needed to keep you as safe as possible.

We have developed a way to stop you, the user, from going to bad or non-productive sites.

If this were not enough, we have a system that monitors your station and reports on incidents.

We have also developed (internally) a system that not only protects you, but it keeps us informed of any failed attempts. Just in case that coveted thumb drive packs more goodies than what you thought.

Firewall

Stops intruders from outside services from coming in to the network. Cannot see encrypted data transferred to and from encrypted sites such as network storage.

If a firewall could do it alone, it would mean that your data is not encrypted and therefore **PUBLIC**

Firewall stops outside attacks from coming into the network.

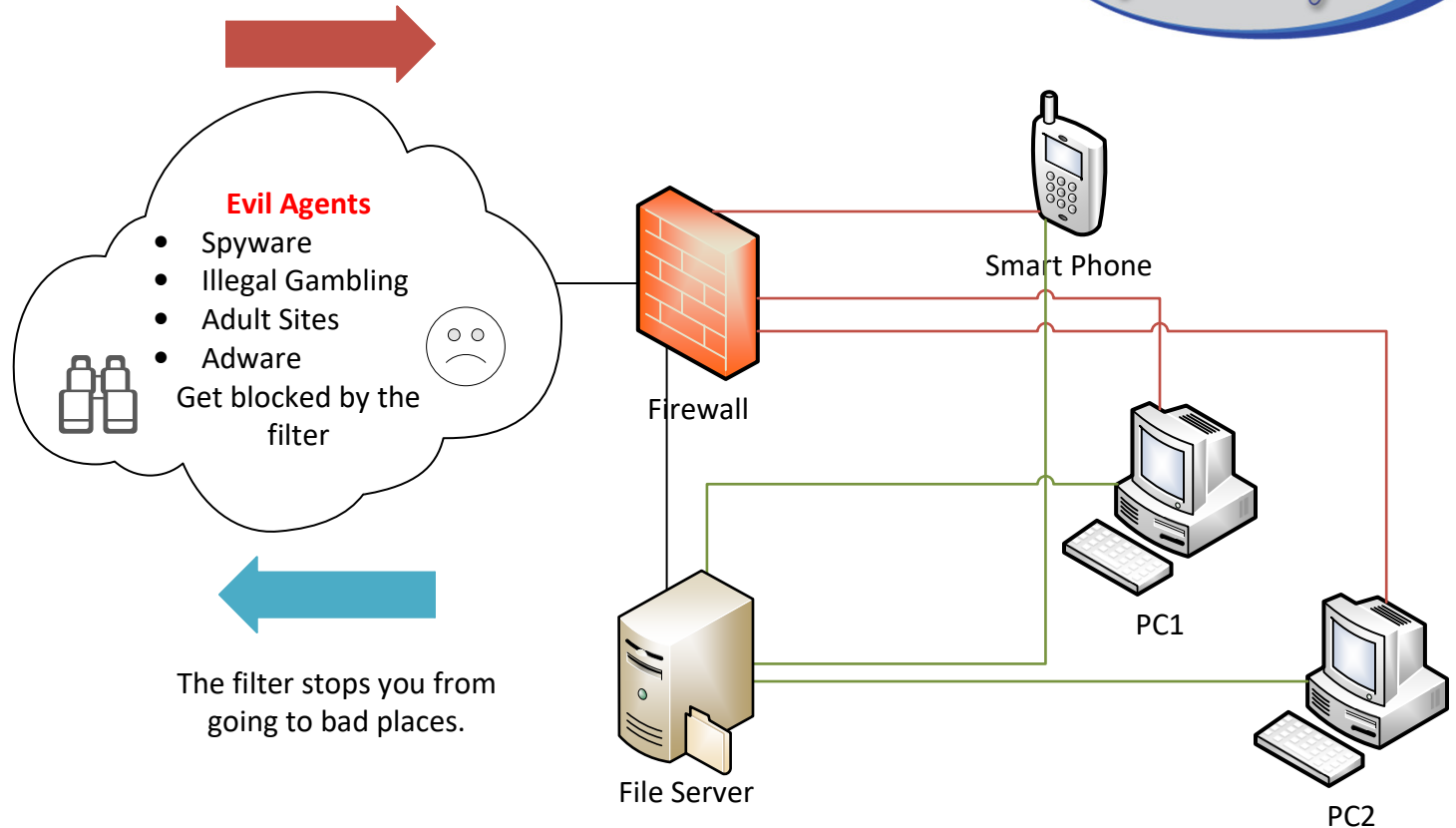

The filter stops you from going to bad places.

SWG

Stops users inside and guests from going to malicious sites and non work related sites.

Spyware installed on mobile devices is stopped from reaching outside servers.

Filtering is based on category of outside resources being reached.

Antivirus

Inspects and protects each device from malicious software that can reach the device from:

- Emails (encrypted or not)
- Valid internet sites
- Local and cloud storage including USB devices